

LOCATION MAP



LEGEND

- 1
- 2
- 3
- 4

PLAY AREA
PLAY EQUIPMENT FOR PRE-SCHOOL AND SCHOOL AGE CHILDREN

WOODCHIP TRAIL
6 FOOT WIDE TRAIL WITH TIMBER STEPS FOR CLIMBING SLOPE

SLED RUN
GRADED SLOPE TO PROVIDE FOR WINTER SPORTS

NATURALIZED PLANTINGS
TO STABILIZE SLOPE, FOR WILDLIFE FOOD + COVER, TO ENHANCE FLOOD-PLAIN.

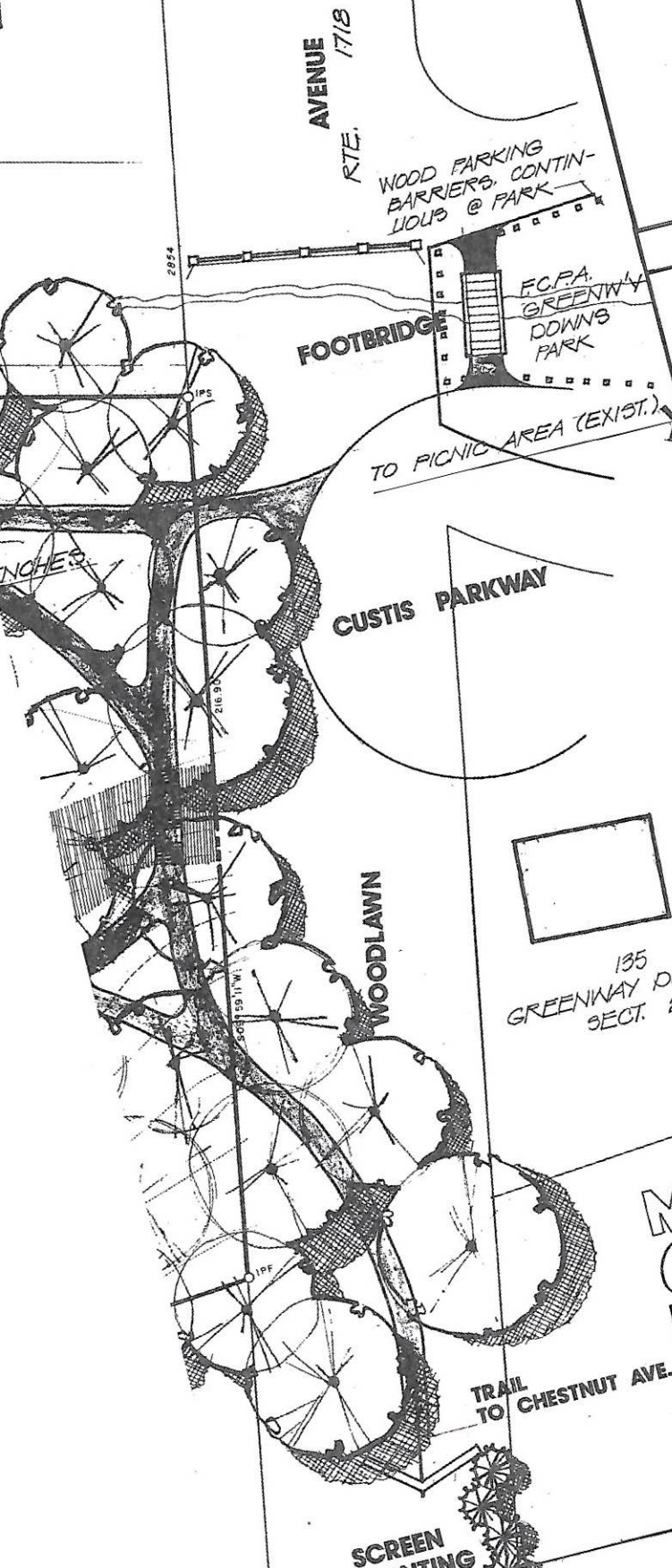

FAIRFAX COUNTY PARK AUTHORITY

ESTELLE R. HOLLEY, CHAIRMAN
LYLE C. MCLAREN, VICE CHAIRMAN
JAMES F. WILD, SECRETARY-TREASURER
FREDERICK M. CRABTREE
NANCY K. CUDY
LORRAINE FOULDS
CALVIN HILL
JOHN MASTENBROOK
ROBERT D. MOSS

JOSEPH P. DOWNS, DIRECTOR
LOUIS A. CABLE, ASSISTANT DIRECTOR
JAMES A. HEBERLEIN, ASSISTANT DIRECTOR
DONALD F. LEDERER, SUPERINTENDENT OF DESIGN
DARYL DEPRENGER, LANDSCAPE ARCHITECT

MASTER PLAN GREENWAY DOWNS PARK

TAX MAP SEC. 50-4 • APPROX 1.5 ACRES • FEBRUARY

BY KILDUFF MAYBERRY & ASSOC.
FOR FAIRFAX COUNTY PARK AUTHORITY
FAIRFAX COUNTY, VIRGINIA

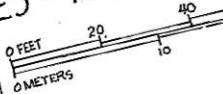



LOCATION MAP

No Scale

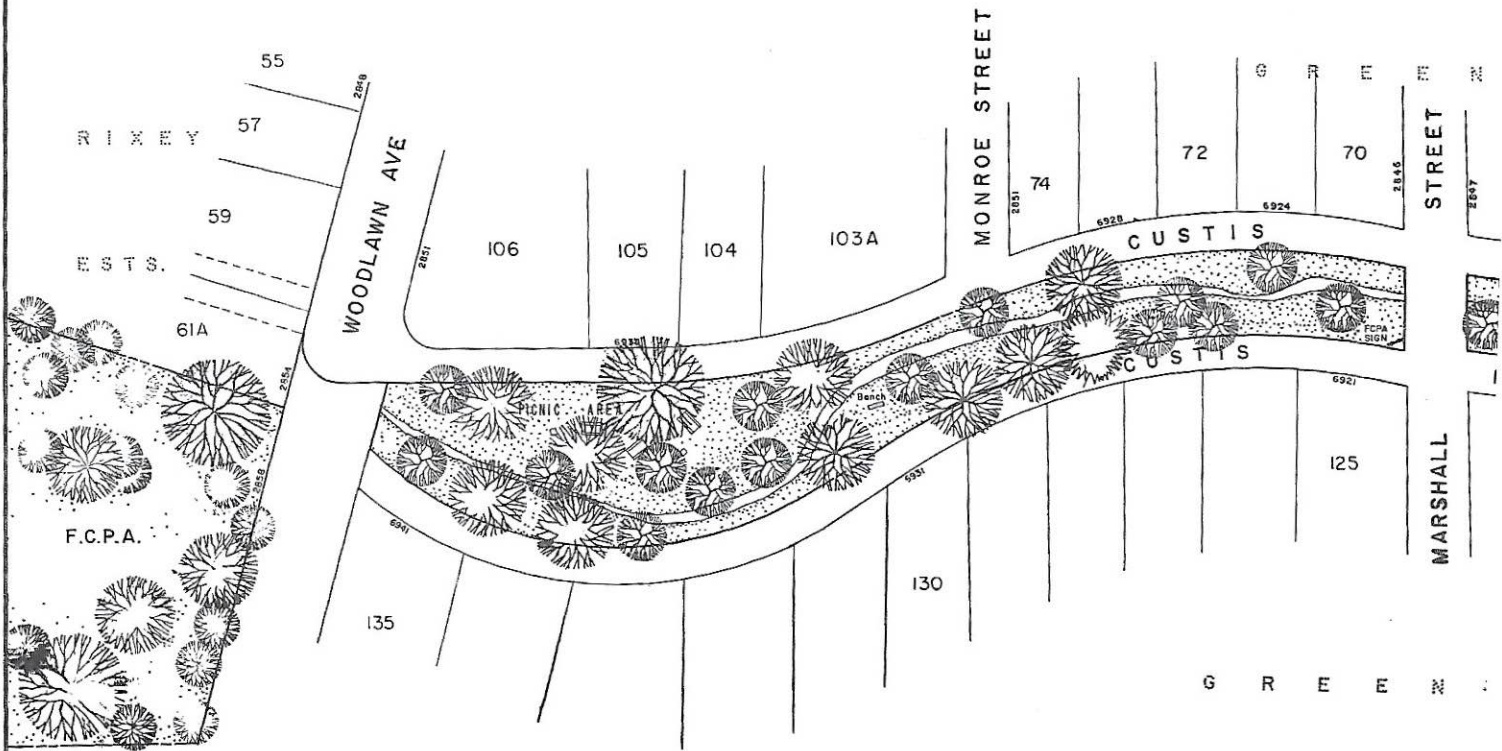

M A S T E R P L A N

GREENWAY DOWNS PARK

FAIRFAX COUNTY VIRGINIA

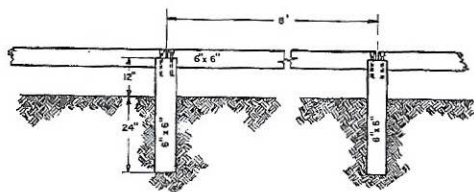

PARKING BARRIER DETAIL
 scale: 1/2" = 1'-0"

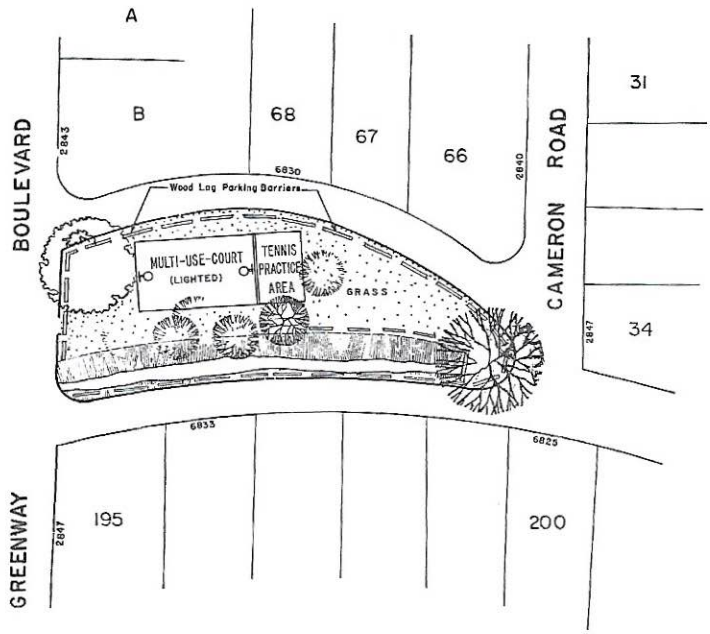
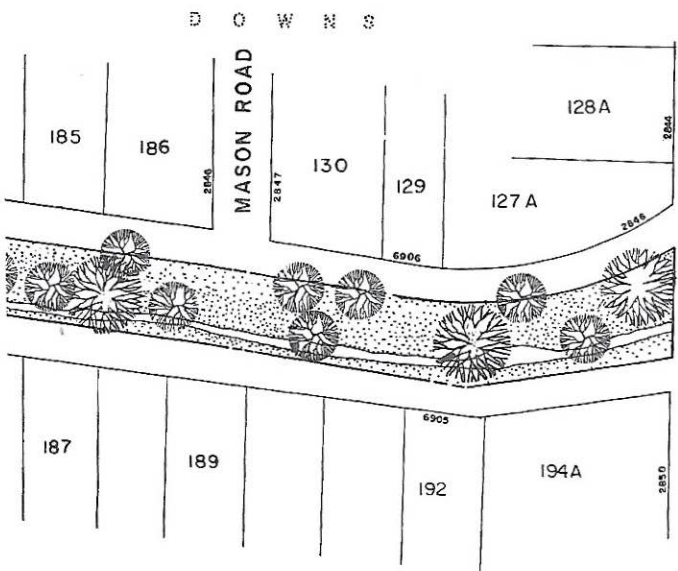

FAIRFAX COUNTY PARK AUTHORITY

- | | |
|--------------------------|----------------------------|
| MRS. NANCY L. BROWN | Chairman |
| PAUL N. PFEIFFER | Vice-Chairman |
| FREDERICK M. CRABTREE | Secretary-Treasurer |
| R. STANLEY BROCKWAY | |
| MRS. ELLAMAE E. DOYLE | |
| NEWTON W. EDWARDS | |
| D. MICHAEL HARVEY | |
| JOHN MASTENBROOK | |
| CARL L. SELL, JR. | |
| MRS. MARTHA H. TALBOT | Director |
| JOSEPH P. DOWNS | Superintendent of Planning |
| DONALD F. LEDERER | Landscape Architect |
| Design: JAY L. JORGENSEN | |

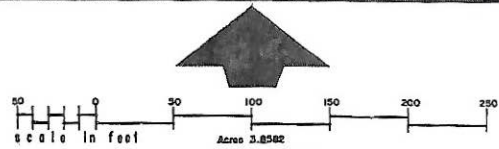

date: OCTOBER, 1973

Fairfax County Park Authority

Director: Joseph P. Downs — Sup't of Planning Donald F. Lederer

EO98-0773-050M

TAX MAP SEC. 50-4